

MILEPOST PLACEMENT

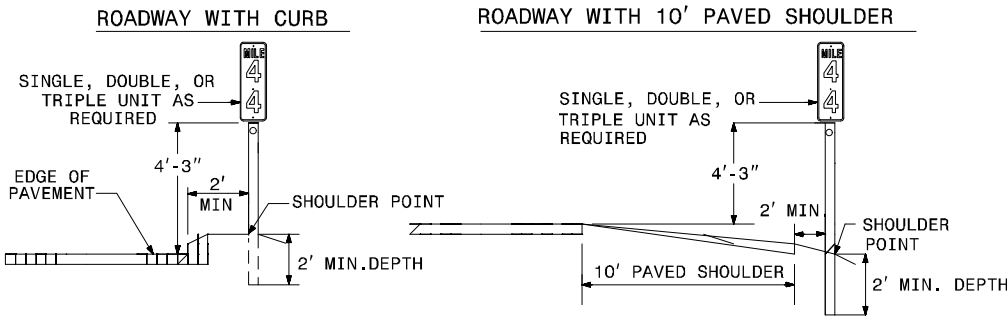

POST DETAILS

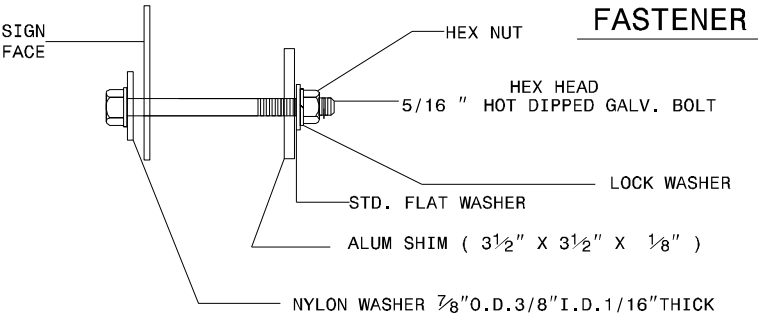
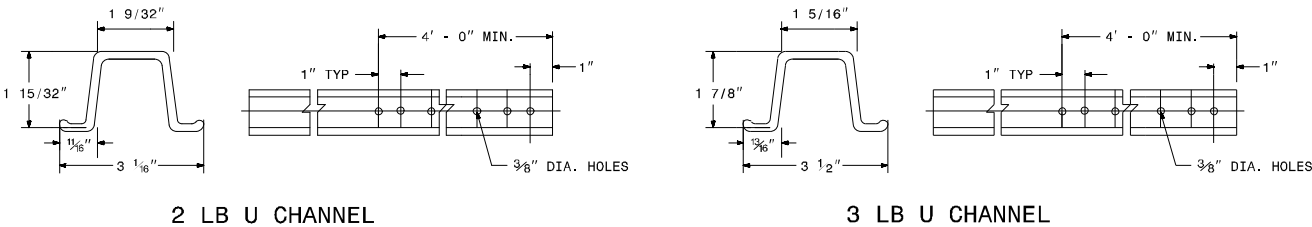

SINGLE UNIT 12" X 24"

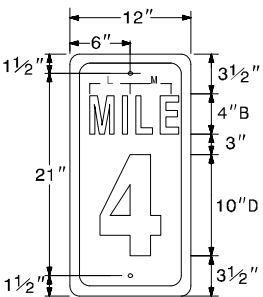

D10-1

DOUBLE UNIT 12" X 36"

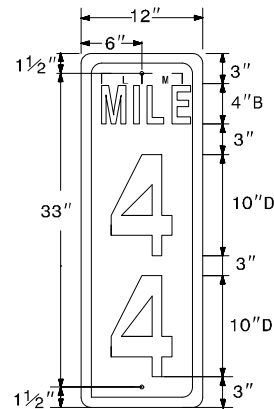

D10-2

TRIPLE UNIT 12" X 48"

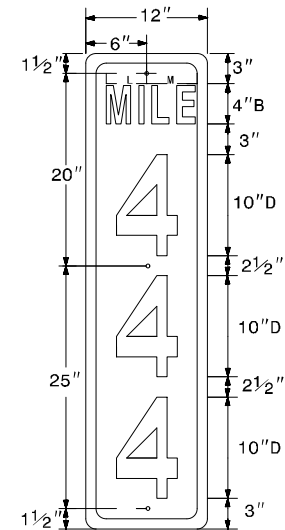

D10-3

MARKER DETAILS

- 1/2" FLUSH BORDER (TYP.)
- 1 1/2" CORNER RADII (TYP.)
- 1/4" DIA. MOUNTING HOLES (TYP.)
- 4 5/8" L DIMENSION (TYP.)
- 4 7/8" M DIMENSION (TYP.)

NOTES:

1. A MILEPOST SHALL CONSIST OF ONE (1) 12" X 24", 12" X 36", OR 12" X 48" MARKER. A ENHANCE REFERENCE LOCATION SIGN SHALL CONSIST OF ONE (1) 12" X 54" OR 12" X 60". MILEPOST SIGNS REQUIRED ONE (1) GALVANIZED STEEL U-CHANNEL POST WEIGHT TWO (2) POUNDS PER LINEAR FOOT AND ENHANCED REFERENCE LOCATION SIGNS REQUIRE ONE (1) 3-LB GALVANIZED STEEL U-CHANNEL SUPPORT.
2. FABRICATE MARKERS FROM .080" SHEET ALUMINUM. EACH MARKER SHALL HAVE SILVER STUCK-ON MESSAGE AND BORDER ON GREEN BACKGROUND. MESSAGE, BORDER, AND BACKGROUND TO BE REFLECTORIZED.
3. USE GALVANIZED STEEL "U" SHAPED CHANNEL POSTS. THE POST'S LENGTH MUST MEET THE REQUIREMENTS SHOWN IN THESE STANDARDS.
4. POSTS SHALL BE DRIVEN. THE TOP OF POST SHALL NOT PROJECT ABOVE THE TOP OF MARKER.
5. ATTACH EACH MARKER TO THE WIDE FACE (FLANGES) OF THE POST BY MEANS OF 5/16" HEX HEAD BOLT, NYLON WASHER, SHIM, FLAT WASHER, LOCK WASHER, HEX NUT FULL CONTACT BETWEEN THE MARKER AND THE POST SHALL BE ACHIEVED. NO BUCKLING OF THE MARKER WILL BE PERMITTED
6. PLACE MILEPOSTS AT THE SHOULDER POINT UNLESS THE ENGINEER DIRECTS OTHERWISE.
7. ENHANCED REFERENCE LOCATION SIGNS SHALL BE PLACED EVERY 2 TENTHS OF A MILE OR AS SHOWN IN THE PLANS.

ENHANCED REFERENCE LOCATION SIGNS

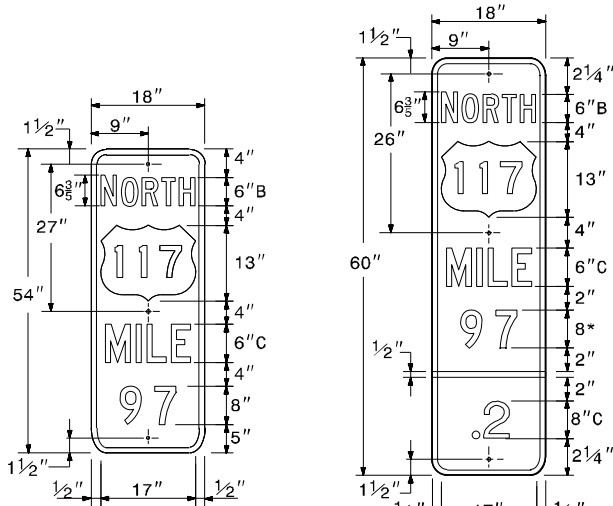

D10-4

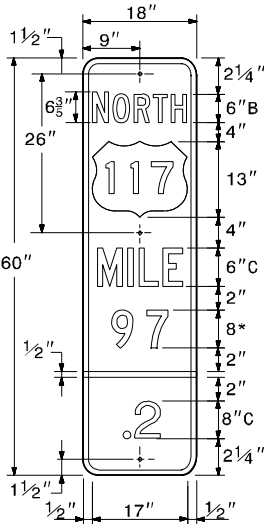

D10-5

ENGLISH DETAIL DRAWING FOR
MILEPOST AND PLACEMENT

8-23

STATE OF
NORTH CAROLINA
DEPT. OF TRANSPORTATION
DIVISION OF HIGHWAYS
RALEIGH, N.C.